

# UBC CONNECTOR

USB standard (USB2.0 Type-C)

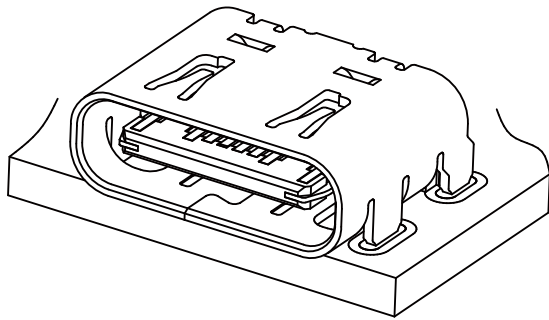

The UBC connector is an USB Type-C compliant interface connector capable of supplying up to 100W of power. The receptacle is a 16-pin design capable of transmitting data at speeds of up to 480 Mbps. Symmetrical plug design, allowing the cable to be inserted in both top and bottom orientations.

- Up to 10,000 high durability mating cycles
- Halogen-free

## Specifications

- Current rating :
    - 1.25 A DC/pin Vbus(A4, A9, B4, B9)  
GND(A1, A12, B1, B12)  
CC1 (A5)  
CC2 (B5)
    - 0.25 A DC/pin Other circuits
  - Voltage rating : 20 V AC
  - Temperature range : -25°C to +85°C  
(including temperature rise in applying electrical current)
  - Contact resistance: Initial value/ 40 mΩ max.  
After environmental tests/ 50 mΩ max.
  - Insulation resistance: 100 MΩ min.
  - Withstanding voltage: There shall be no breakdown or flashover while applying 100 VAC for one minute.
- \* Please refer to the "Handling Precautions for Terminals and Connectors" on our website (listed in the "Technical Documents" column on the Product Information page) before use.
- \* RoHS2 compliance
- \* Dimensional unit: mm
- \* Contact JST for details.

## Receptacle (On-board specification)

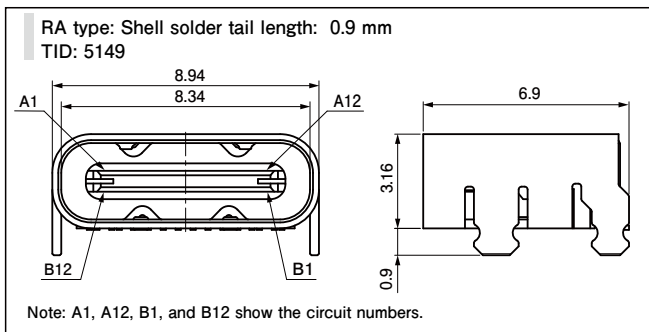

| Modl No.      | Q'ty/reel |
|---------------|-----------|
| UBC-RA-TF(HF) | 1,500     |

| Material and Surface finish, etc. |                                     |
|-----------------------------------|-------------------------------------|
| Contact                           | Copper alloy, selective gold-plated |
| Housing                           | LCP, black                          |
| Shell                             | Stainless steel, nickel-plated      |
| Mid plate                         | Stainless steel                     |

For flame retardant grade of resin material used, please refer to the "List of Registered Overseas Standards" on our website (listed in the "Technical Documents" column on the Product Information page).

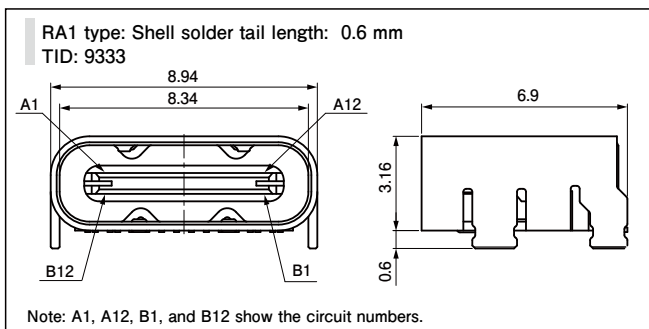

| Model No.      | Q'ty/reel |
|----------------|-----------|
| UBC-RA1-TF(HF) | 1,500     |

| Material and Surface finish, etc. |                                     |
|-----------------------------------|-------------------------------------|
| Contact                           | Copper alloy, selective gold-plated |
| Housing                           | LCP, black                          |
| Shell                             | Stainless steel, nickel-plated      |
| Mid plate                         | Stainless steel                     |

For flame retardant grade of resin material used, please refer to the "List of Registered Overseas Standards" on our website (listed in the "Technical Documents" column on the Product Information page).

